

INSTALLATION INSTRUCTIONS

In order to obtain a good result, we advise all parties to follow all given instructions carefully.

National regulations regarding floor applications must always be followed.

Please make sure that the floor user has a copy of this document.

PREPARATION

FITXPRESS 

UNICLIC 
PATENTED TECHNOLOGY

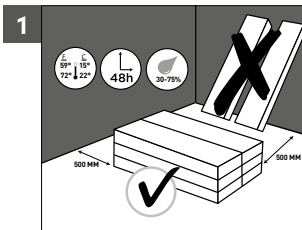

Let the planks acclimatize for 48 hours in the unopened packaging at the normal room temperature, in the middle of the room where the floor is to be installed. The ideal conditions are 15-22°C at a relative humidity of 30-75%. If climate conditions are outside this 30-75% range, we strongly advise to acclimatize for 1 week with opened packages.

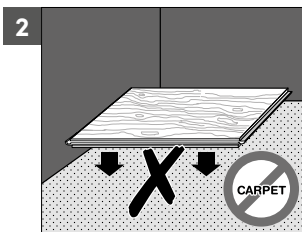

Remove any damp-porous floor covering (carpet, needle felt, etc.) first. Damp-sealed floor covering (PVC, linoleum, VCT, etc.) does not have to be removed. Always use a dampproof underlay.

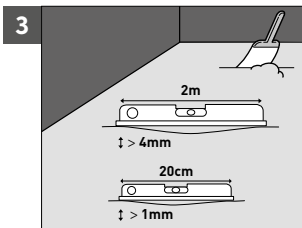

Make sure the subfloor is level. Any unevenness greater than 4 mm over the length of 2 meter must be smoothed out. The same applies to any unevenness of more than 1 mm over a length of 20 cm. After checking the subfloor for unevenness, carefully vacuum the entire surface. Make sure that the floor base is flat, clean, firm, and dry. To avoid risk of squeaking, secure any loose particleboard, OSB, fiberboard, timber planks etc. with screws.

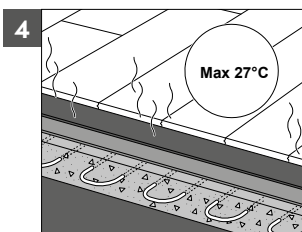

Additional instructions apply if there is underfloor heating or cooling. For health and safety reasons and to avoid problems with you floor, certain important basic rules need to be followed:

Floor Heating

- Firstly it is very important to ensure a floor surface temperature of maximum 27°C (80°F).
- A suitable underlay must be chosen. The total Thermal Resistance (R) of your laminate floor in combination with the underlay must be not higher than 0,15 m²K/W.
- Always change the temperature gradually at the start and end of a heating period.
- Finally try to avoid heat accumulation by carpets or rugs or by leaving insufficient space between furniture and the floor.
- Some water based and electrical floor heating systems are permitted. See separate installation instruction Floor Heating and Floor Cooling.

Floor Cooling

- For floor cooling, a heat-resistance of < 0.15m²K/W is prescribed. The heat-resistance of a laminate varies between 0.06 m²K/W and 0,15 m²K/W (with underlay). So account should be taken here of a certain small loss of capacity.
- Ensure a proper safety system including automatic sensors that detect when the dew point (= start of condensation) is reached below or in the floorcoverings and then switch off the cooling.

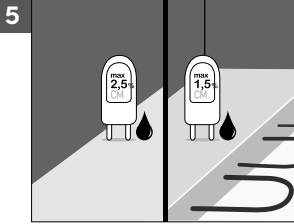

Mineral subfloors (such as concrete) must be sufficiently dry prior to installation. Installation on cement subfloor requires a CM < 2,5% (75 % RH). An installation on anhydrite subfloor requires a CM < 0,5 % (50% RH). If the moisture content is higher or may become higher other types of damp proofing must be used.

If floor heating is used, cement subfloor requires a CM < 1,5% (60% RH) and anhydrite subfloor requires a CM < 0,3 (40% RH). (see Floor Heating Instructions)
Always measure, record and keep your moisture content results.

A new cement screed floor must dry at least 1 week per 1cm (3/8") thickness up to 4cm (1-1/2"). Thicknesses over 4cm (1-1/2") require twice as much drying time. For example, a 6cm (2-1/2") concrete subfloor must dry at least 8 weeks. For renovations, always measure the moisture content in all the different subfloor-layers and make sure that they are than than the mentioned values.

Best practice should be followed to avoid bacteria and mould growth under the floorcovering: Direct-to-earth mineral subfloors must have an effective damp proof membrane (DPM) in accordance with the national standards for the installation of laminate floorcoverings.

In most cases such a DPM has been installed during the building process, if not, post-construction solutions are available on the market. Where necessary, follow the manufacturer's detailed instructions for the installation of a surface applied DPM and the use of levelling compound.

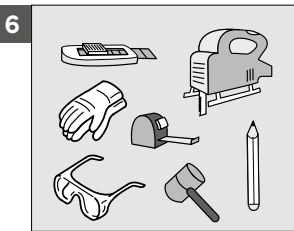

To install your laminate floor, you need the following standard tools: Hammer, saw (a jig-saw, hand circular saw, hand saw, or cross-cut saw), mouth mask (during sawing), pencil, tape measure, safety goggles and gloves.

Apart from that, you also need the following accessories: SmartFinish installation kit (SFTOOL: a pulling iron, spacers and a tapping block), underlay system (use an underlay that provides a stable foundation for the floor) and suitable maintenance products.

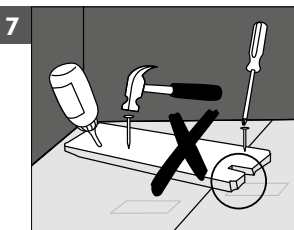

Check all panels before and during installation. Defective panels must never be used. An installed plank is considered as accepted and cannot be claimed.

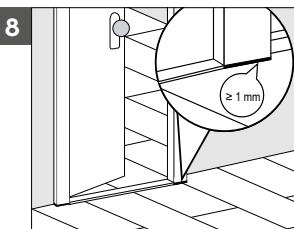

Check that the doors can still open and close after the floor and underlay have been installed. If the doorframe is installed after the floor installation, please make sure that a min. 1mm vertical gap is left between the base of the doorframe and the surface of the floor.

PREPARATION

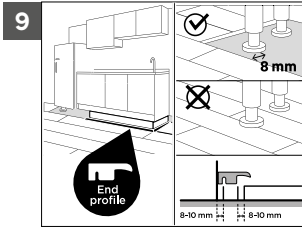

Cooking islands for kitchens and other very heavy objects should be installed first and not placed on top of the laminate. The laminate floor must be able to move around the heavy objects to avoid open joints and separating planks.

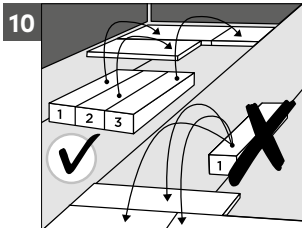

Make sure the panels are mixed sufficiently when you install them, so that you do not end up with too many identical, light or dark panels next to each other. To obtain the best visual effect, it is best to fit the floorboards in the direction of the longest wall and parallel to the incidence of light.

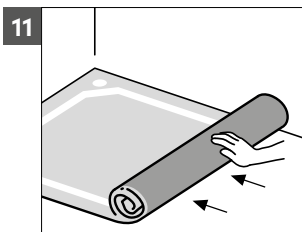

First install the underlay, per width and gradually as you progress. It is vital that you use underlays to smooth any unevenness in the base floor. The smooth top surface makes installing the laminate panels easier and ensures ample expansion afterwards. You can find more information about underlays and how to install them on the underlay packaging or at your dealer.

INSTALLATION

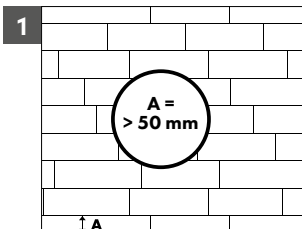

Before starting, carefully measure the length and the width of the room to plan a precise layout to achieve a balanced appearance of the floor. This is very important when installing typical tile decors. This will ensure also you won't end up with the last row being too narrow. If the last row would be less than 50mm, the installation will be easier if you cut down the planks of the first row in the length.

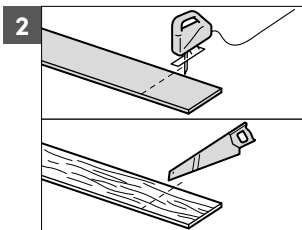

Of course we also need to saw the panels. To obtain a clean cut, the pattern side should face down when you use a jigsaw, sabre saw or circular handsaw and up when you use a handsaw or a crosscut saw.

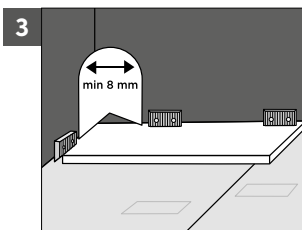

Begin the first row with a whole plank. First saw off the tongue on both the long and the short sides. Put the plank with sawn off sides against the walls. Put spacers from the installation kit between the planks and the wall. This will ensure that your expansion gap is wide enough: 8 to 10 mm (5/16" to 3/8").

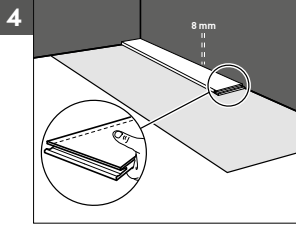

Start with the first plank that will be installed in the corner. Remove the click profile on both the long and the short side of the plank by sawing. For other planks of the first row (not in the corner), remove the click profile on the long side that will be directly next to the wall. Any side of a plank that is directly next to a wall, must have its click profile removed, in order to ensure the required expansion gap.

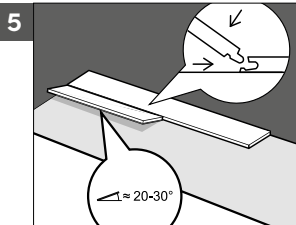

In order to make the start of the installation easier, assemble the first 3 rows away from the wall, so you can sit on the planks during the assembly. Then slide the first 3 rows at the wanted position close to the wall with distance spacers in place. Take a thin rope and hold it alongside the installed planks to check and adjust the straightness of your installed first 3 rows. It is recommended to make additional checks of the straightness, in order to confirm the straightness during the installation. Remember to use the distance spacers for the expansion gap of 8mm (0,315 inch) along the perimeter.

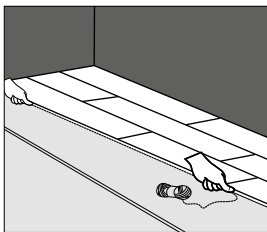

Uniclic® is unique because you can install the planks in two different ways.



Method A (angle-angle): First, rotate the short side of the plank to be installed, into the short side of the already installed plank, by means of the angle principle. Then raise the newly installed plank to an angle of 20-30°. This will also raise the previously installed planks in the same row, because their short sides are already connected. Now place your BOTH hands close to the joint and pull the long side of the plank towards you. The panels will now click together. You can either insert the tongue into the groove, or the groove into the tongue. The tongue in groove method is the most common and easiest way.

The easiest way to connect FitXpress planks is by a rotating fold down movement. Lift the connecting plank up in an angle of 20-30 degrees, push it into the long side groove and slide it gently to the left until the plank ends meets. Push the plank firmly downwards to the floor, and the FitXpress will lock the joint perfectly in the end. Always control each joint before continuing. Use the tapping block gently to tighten up small gaps if needed. Install the first 2 rows in accordance to the illustration.

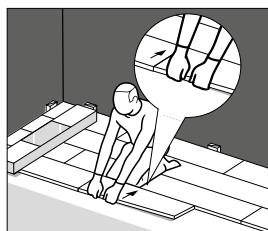
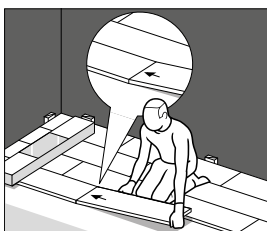
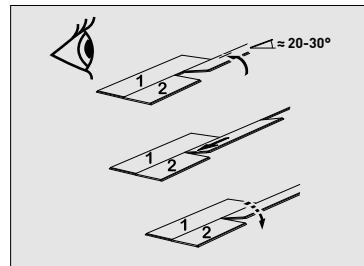
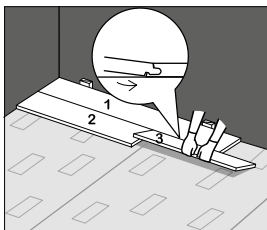
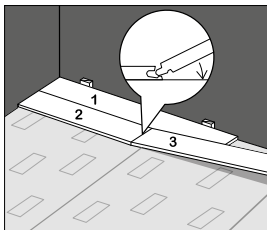
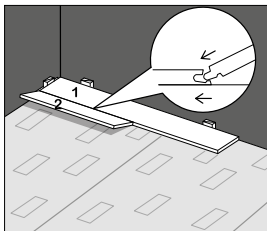

7 

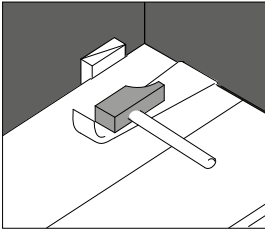

With Uniclic® you can also tap the panels into each other without lifting. For this method you must use the special Uniclic® tapping block. The planks should not be joined with a single tap. To avoid damaging the panels you must tap them together gradually.

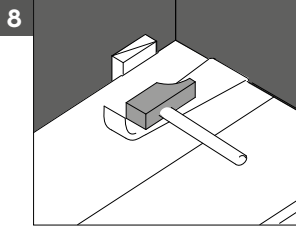

In places where it is too difficult to install the planks, you can tap them together using the pulling iron and a hammer.

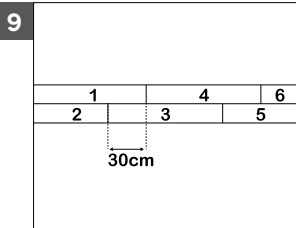

Ensure that the end joints of the panels in two successive rows are never in line. Always ensure that the joints are staggered by at least 30 cm / 12 inches. Continue like this to the end of the room.

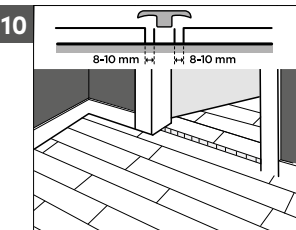
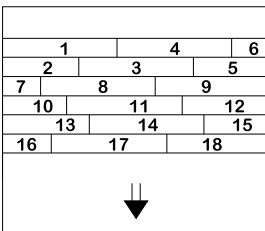

Room humidity can vary according to the season, so it is vital that the floor is able to expand and contract. For this reason, make sure you leave an expansion gap of minimum 8 to 10 mm (5/16" to 3/8") on all sides of the floor, around pipes, thresholds and under doors. Expansion gaps can be finished by means of a skirting that is attached to the subfloor. It is mandatory to provide an expansion gap between different rooms (e.g. under the door). In typical T, - L or U- shaped rooms it may also be necessary to install an expansion gap. Contact the Unilin technical department in case of doubt.

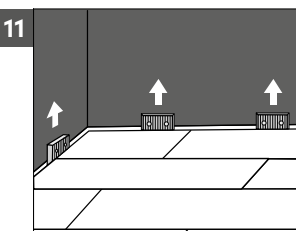

Remove all spacers.

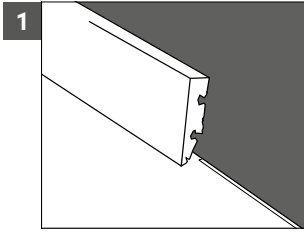

1 Install the skirting against the wall. Never attach the skirting to the floor. This method allows the floor to expand and contract under the skirting. Do not fill or cover the expansion gaps with silicone or other kit.

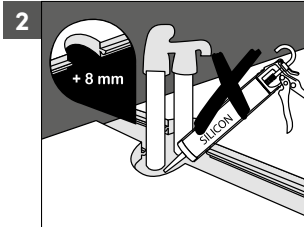

2 For a perfect finish around pipes, use pipe covers.

FINISHING OF THE FLOORING IN WET AREAS: **ONLY FOR WATERRESISTANT LAMINATE**

These installation instructions can prevent water infiltration around the perimeter and obstacles of your laminate flooring in wet areas (areas with direct access to outside, areas with risk or dropped liquid on the surface, ...). Following these instructions carefully makes the floor fit for use in ANY room which does not have a build-in floor drain. The water-resistant floor is not suitable for use in damp spaces like showers, pool areas, saunas and rooms with build-in floor drains. Please note that some national regulations are not allowing floating installation in wet rooms. National regulations regarding floor applications must always be followed.

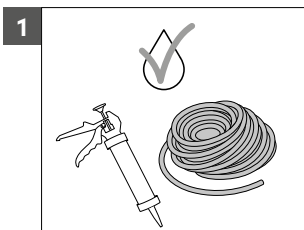

1 For a water resistant finishing, use SmartFinish AquaProtect kit and the Foamstrip.

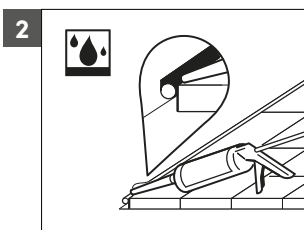

2 Sealing the perimeter expansion gaps combining the compressible PE Foamstrip with diameter 8 to 10 mm and the flexible and AquaProtect kit. Push the Foamstrip in the expansion gaps and apply SmartFinish AquaProtect kit under slight angle towards the floor.

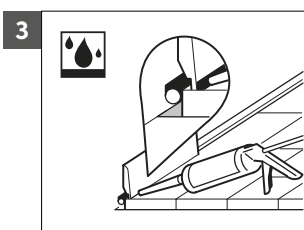

3 Install the skirting with mounting adhesive. Apply AquaProtect kit between skirtings and floor to avoid ingress of water. Tip: Moisten a spatula or your finger in a soap solution (water with detergent) and smooth the applied kit. To make work more clean, it can be easy to put a tape on the floor before applying AquaProtect kit. This tape can be removed immediatly after applying the silicone kit. Spilled AquaProtect kit can be removed easily when it is dry.

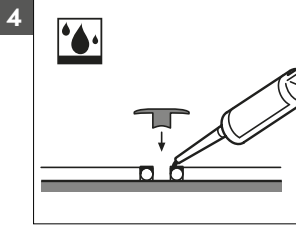

4 Fix the base of your incizo profile to the base floor with mounting adhesive and/or screws. Apply AquaProtect kit on the Foamstrip that is in the expansion gap.

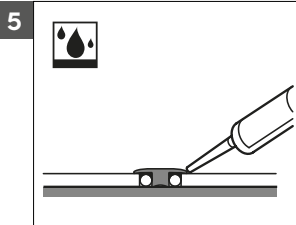

5 Push the transition profile in the base profile and the wet Aquaprotect. Seal the joint between your floor and profile with AquaProtect kit. To smooth the kit use again the soap solution.

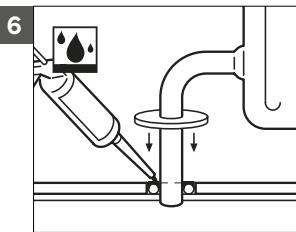

6 For a perfect finish around pipes, use pipe covers and SmartFinish AquaProtect kit on top of the Foamstrip. Then place the pipe cover and apply Aquaprotect around the pipe cove and around the tubes. This makes the ingress of water impossible.

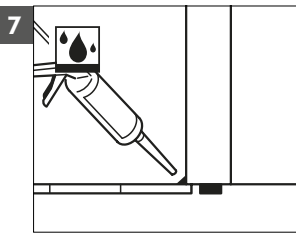

7 To secure extra water protection around the perimeter of the floor and avoid water to enter underneath the panels, apply AquaProtect kit up to the wall base, thresholds, door frames, pipe covers etc.

MAINTENANCE

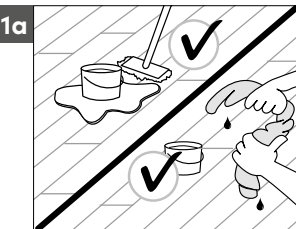

1a: Slightly damp and wet maintenance is allowed on water resistant laminate.

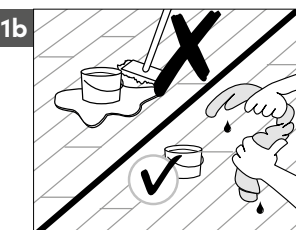

1b: Wet maintenance is absolutely forbidden on non-water resistant laminate.

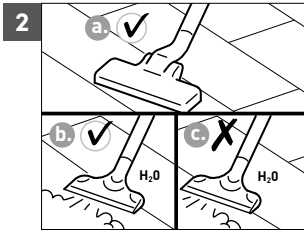

2a: For dry maintenance, we advise a vacuum cleaner. Make sure the vacuum cleaner is equipped with soft wheels and a special parquet brush to avoid scratches on your floor.

2b: You can use a steam cleaner on the pressed bevel ranges, if there's no steam directly coming on the laminate. So it must always be used with an appropriate cloth on the steam opening, which guarantees also an homogeneous heat and steam distribution. It is also important to take care to hold the apparatus not too long on the same place and clean the floor in the length direction of the planks.

2c: For the other ranges, we recommend to never use a steam cleaner.

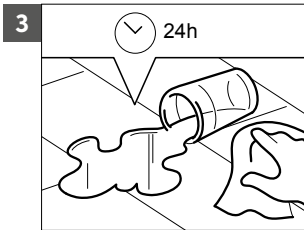

Remove any water within 24 hours on pressed bevel ranges. For other water resistant ranges, within 12 hours and for non-water resistant laminate within 15 minutes.

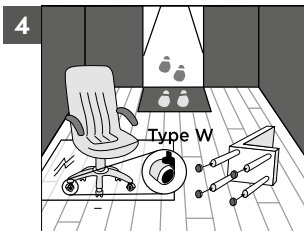

Protect furniture and chair legs. Avoid bringing dirt, water and sand indoors by providing a suitable floor mat at the door. Use (office) chairs and seats with soft wheels that are suitable for a laminate floor and/or use a suitable desk mat.

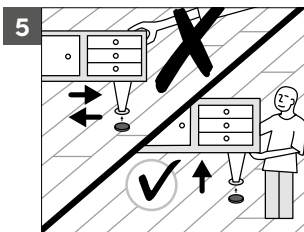

Never drag items of furniture over the floor, but lift them up.

RECYCLING

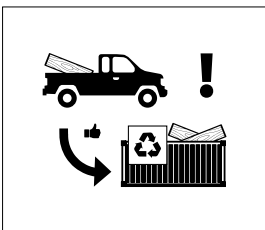

Deliver installation waste or a disassembled floor to a recognized waste collection facility or recycling centre as 'nonhazardous treated wood'.